

ESA Drop in Anchor



Features

- European Technical Approval Option 10 in uncracked concrete
- German National Approval
- Use in reinforced or non reinforced concrete
- Quick and simple installation
- Shallow drilling depth
- Stainless steel for outdoor applications
- Zinc plated > 5µm
- Face fixing



Applications

pipes, ventilation systems, cable trays

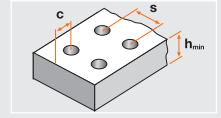
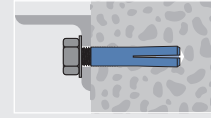
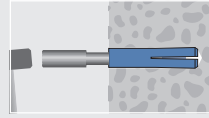

Technical Data

	Concrete C20/25 tension load (kN)	Min. distance betw. anchors (smin) mm	Min. edge distance (e_min) mm	Min. thickness of fo. (h_min) mm	Tighten torque (Nm)
SB M6	1.5	80	80	100	5
SB M8	2	90	90	100	8
SB M10	3	120	120	120	15
SB M12	5.3	150	150	150	35
SB M16	7.4	200	200	180	60
SB M20	11	260	260	200	120

The partial safety factors of the resistances as well as a partial safety factor of the effect of $\gamma_F = 1.4$ are considered / 1 kN \approx 100 kg

Installation

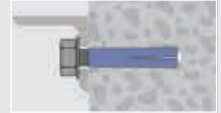
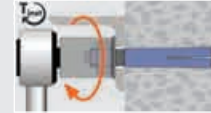
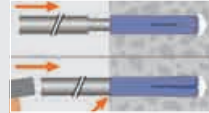
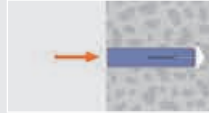
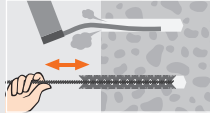
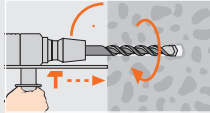

Article code	Internal thread	Thread length mm	Plug and drill \varnothing mm	Drilling depth mm	Box contents	Outer carton
¹⁾ 1740006	M6	11	8	33	100	1000
1740008	M8	13	10	33	100	1000
1740010	M10	15	12	44	50	500
1740012	M12	18	15	54	50	400
⁴⁾ 1740013	M12	18	16	54	50	-
¹⁾ ¹⁹⁾ 1740016	M16	23	20	71	25	250
¹⁾ ¹⁹⁾ 1740020	M20	34	25	86	25	50

¹⁾ Not part of the approval ¹⁹⁾ Not part of the German National Approval ⁴⁾ for use with diamond drill rigs and saws

ESA (SB) Drop in Anchor



Article code	Internal thread	Thread length mm	Plug and drill \varnothing mm	Drilling depth mm	Box contents	Outer carton
1750006	M6	11	8	33	100	-
1750008	M8	13	10	33	100	1000
1750010	M10	15	12	44	50	500
1750012	M12	18	15	54	50	400
¹⁹⁾ 1750016	M16	23	20	71	25	-

¹⁹⁾ Not part of the German National Approval

ESAr Drop in Anchor, stainless steel A4/316



Article code	Internal thread	Thread length mm	Plug and drill \varnothing mm	Drilling depth mm	Box contents (FS)	Outer carton
¹⁹⁾ 1740206	M6	11	8	33	100	2400
¹⁹⁾ 1740208	M8	15	10	33	100	2400
¹⁹⁾ 1740210	M10	17	12	44	50	1200
¹⁹⁾ 1740212	M12	20	15	54	50	600
¹⁹⁾ 1740216	M16	30	20	71	25	300

¹⁹⁾ Not part of the German National Approval

ESAK Drop in Anchor with collar



Article code	For	Box contents
1770006	M6	1
1770008	M8	1
1770010	M10	1
1770012	M12	1
1770016	M16	1
1770020	M20	1

ESA-WZ Setting Tool for ESA



Article code	For	Box contents
1770001	ESA-WZ	1

ESA-HG Hand Guard for ESA-WZ

