

MB Nylon Frame Plug for softer materials

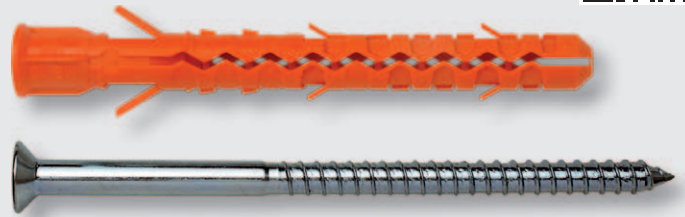

Features

- ETAG 020 - Approved for multiple use in concrete and masonry for non-structural applications
- Fire resistance test certification F90 for fastening of façade systems
- Aerated Concrete: Drill-Ø 9mm, setting depth 90mm
- Plug made from high-quality polyamide PA6
- Through fixing
- Indoor (zinc plated) and outdoor (stainless steel) applications



Applications

façade fixings, profiles, substructures, frames

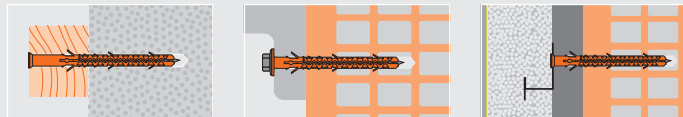

Technical Data

	Perforated Brick app. load (kN)	Lightweight Concrete app. load (kN)	Aerated Concrete app. load (kN)	Bending moment (Nm) galv. steel	Bending moment (Nm) stainl. steel
MB 8	0.4	0.20	-	3.4	3.2
MB 10	0.8	0.3	0.3	11.1	10.4

Important: Recommended loads / Without hammer drilling in perforated brick and lightweight concrete / 1 kN ≈ 100 kg / Safety factor of 3 is included / Approved loads: Tension, shear and combined loads / Values only valid when using Mungo safety screws / Approved loads and detailed specifications of stones can be found in the approval ETA-15/0068

Installation

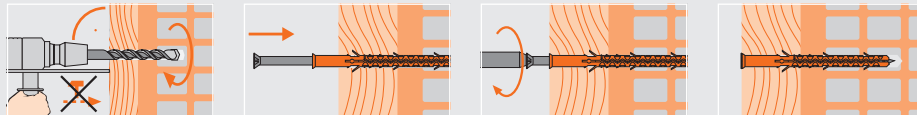

Article code	Plug and drill Ø mm $d_{nom} = d_0$	Length mm L	Usable length mm f_{fix}	Screw Ø mm d_s	Screw length mm L_s	Drive	Box content	Outer carton	Quantity per pallet
¹¹ 1122100	8	80	10	6	85	T30	100 ⁵¹	600 ³²	14400
¹¹ 1122101	8	100	30	6	105	T30	100 ⁵¹	600 ³²	14400
¹¹ 1122102	8	120	50	6	125	T30	100 ⁵¹	600 ³²	14400
¹¹ 1122104	8	140	70	6	145	T30	100 ⁵¹	600 ³²	14400
1122108	10	80	10	7	85	T40	100 ⁵¹	600 ³²	14400
1122110	10	100	30	7	105	T40	50 ⁵¹	300 ³²	7200
1122112	10	120	50	7	125	T40	50 ⁵¹	300 ³²	7200
1122114	10	140	70	7	145	T40	50 ⁵¹	300 ³²	7200
1122116	10	160	90	7	165	T40	50 ⁵¹	300 ³²	7200
1122120	10	200	130	7	205	T40	50 ⁵¹	300 ³²	7200
¹⁷ 1122124	10	240	170	7	245	T40	25	-	-
¹⁷ 1122128	10	280	210	7	285	T40	25	-	-
¹⁷ 1122130	10	300	230	7	305	T40	25	-	-

¹⁷ Pre-assembled
¹¹ Not part of the approval

Article code	Plug and drill Ø mm $d_{nom} = d_0$	Length mm L	Usable length mm f_{fix}	Screw Ø mm d_s	Screw length mm L_s	Wrench size SW	Box content	Outer carton	Quantity per pallet
1121908	10	80	10	7	85	13	100 ⁵¹	600 ³²	14400
1121910	10	100	30	7	105	13	50 ⁵¹	300 ³²	7200
1121912	10	120	50	7	125	13	50 ⁵¹	300 ³²	7200
1121914	10	140	70	7	145	13	50 ⁵¹	300 ³²	7200
1121916	10	160	90	7	165	13	50 ⁵¹	300 ³²	7200
1121920	10	200	130	7	205	13	50 ⁵¹	300 ³²	7200
¹⁷ 1121924	10	240	170	7	245	13	25	-	-
¹⁷ 1121928	10	280	210	7	285	13	25	-	-
¹⁷ 1121930	10	300	230	7	305	13	25	-	-

¹⁷ Pre-assembled

Article code	Plug and drill Ø mm $d_{nom} = d_0$	Length mm L	Usable length mm f_{fix}	Screw Ø mm d_s	Screw length mm L_s	Drive	Box content	Outer carton	Quantity per pallet
¹¹ 1122300	8	80	10	6	85	PZ3	100 ⁵¹	600 ³²	14400
¹¹ 1122301	8	100	30	6	105	PZ3	100 ⁵¹	600 ³²	14400
¹¹ 1122302	8	120	50	6	125	PZ3	100 ⁵¹	600 ³²	14400
¹¹ 1122304	8	140	70	6	145	PZ3	100 ⁵¹	600 ³²	14400
1122308	10	80	10	7	85	PZ3	100 ⁵¹	600 ³²	14400
1122310	10	100	30	7	105	PZ3	50 ⁵¹	300 ³²	7200
1122312	10	120	50	7	125	PZ3	50 ⁵¹	300 ³²	7200
1122314	10	140	70	7	145	PZ3	50 ⁵¹	300 ³²	7200
1122316	10	160	90	7	165	PZ3	50 ⁵¹	300 ³²	7200
1122320	10	200	130	7	205	PZ3	50 ⁵¹	300 ³²	7200

¹¹ Not part of the approval

MB-ST Nylon Frame Plug with screw T30/T40

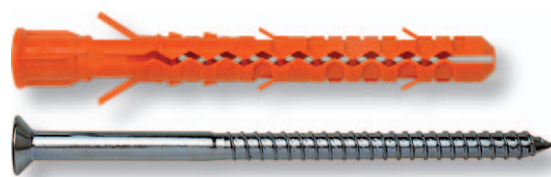

MB-SS Nylon Frame Plug with hexagon screw



MB-S Nylon Frame Plug with screw Pozi 3

