

MBR Nylon Frame Plug for solid materials



Features

- ETAG 020 - Approved for multiple use in concrete and masonry for non-structural applications
- Fire resistance test certification F90 for fastening of façade systems
- Plug made from high-quality polyamide PA6
- Through fixing
- Indoor (zinc plated) and outdoor (stainless steel) applications



Applications

façade fixings, profiles, substructures, frames

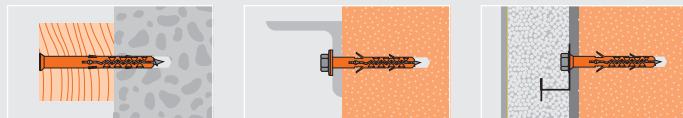

Technical Data

	Concrete ≥ C12/15 app. load (kN)	Sandstone app. load (kN)	Brick app. load (kN)	Bending moment (Nm) galv. steel	Bending moment (Nm) stainl. steel
MBR 6	0.3	0.25	0.25	-	-
MBR 8	0.5	0.4	0.4	3.4	3.2
MBR 10	0.8	0.6	0.6	9.2	8.6
MBR 10x60	0.8	0.6	0.6	7.9	7.4

Important: Recommended loads / 1 kN ≈ 100 kg / Safety factor of 3 is included / Approved loads: Tension, shear and combined loads / Values only valid when using Mungo safety screws / Approved loads and detailed specifications of stones can be found in the approval ETA-15/0068

Installation

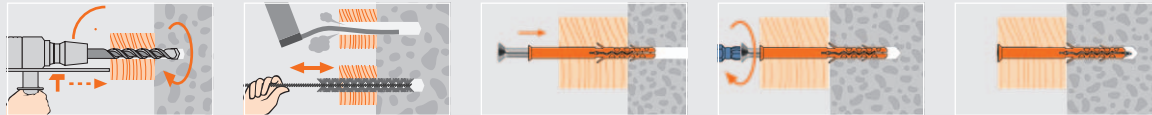

Article code	Plug and drill \varnothing mm $d_{nom} = d_d$	Length mm L	Usable length mm f_{fix}	Screw \varnothing mm d_s	Screw length mm L_s	Drive	Box content FS	Outer carton SK	Quantity per pallet
¹¹ 1122000	8	80	30	6	85	T30	100 ⁵¹	600 ³²	14400
¹¹ 1122001	8	100	50	6	105	T30	100 ⁵¹	600 ³²	14400
¹¹ 1122002	8	120	70	6	125	T30	100 ⁵¹	600 ³²	14400
¹¹ 1122004	8	140	90	6	145	T30	100 ⁵¹	600 ³²	14400
1122006	10	60	10	7	65	T40	100 ⁵¹	600 ³²	14400
1122008	10	80	30	7	85	T40	100 ⁵¹	600 ³²	14400
1122010	10	100	50	7	105	T40	50 ⁵¹	300 ³²	7200
1122012	10	120	70	7	125	T40	50 ⁵¹	300 ³²	7200
1122014	10	140	90	7	145	T40	50 ⁵¹	300 ³²	7200
1122016	10	160	110	7	165	T40	50 ⁵¹	300 ³²	7200
¹⁷ 1122020	10	200	150	7	205	T40	50 ⁵¹	300 ³²	7200
¹⁷ 1122024	10	240	190	7	245	T40	25	-	-

¹⁷ Pre-assembled

¹¹ Not part of the approval

MBR-ST Nylon Frame Plug with screw T30/T40



Article code	Plug and drill \varnothing mm $d_{nom} = d_d$	Length mm L	Usable length mm f_{fix}	Screw \varnothing mm d_s	Screw length mm L_s	Wrench size SW	Box content FS	Outer carton SK	Quantity per pallet
1121506	10	60	10	7	65	13	100 ⁵¹	600 ³²	14400
1121508	10	80	30	7	85	13	100 ⁵¹	600 ³²	14400
1121510	10	100	50	7	105	13	50 ⁵¹	300 ³²	7200
1121512	10	120	70	7	125	13	50 ⁵¹	300 ³²	7200
1121514	10	140	90	7	145	13	50 ⁵¹	300 ³²	7200
1121516	10	160	110	7	165	13	50 ⁵¹	300 ³²	7200
¹⁷ 1121520	10	200	150	7	205	13	50 ⁵¹	300 ³²	7200
¹⁷ 1121524	10	240	190	7	245	13	25	-	-

¹⁷ Pre-assembled

MBR-SS Nylon Frame Plug with hexagon screw



Article code	Plug and drill \varnothing mm $d_{nom} = d_d$	Length mm L	Usable length mm f_{fix}	Screw \varnothing mm d_s	Screw length mm L_s	Drive	Box content FS	Outer carton SK	Quantity per pallet
¹¹ 1120906	6	55	25	4	60	PZ2	100 ²¹	1800 ³²	43200
¹¹ 1120907	8	60	10	6	65	PZ3	100 ³¹	1200 ³²	28800
¹¹ 1120908	8	80	30	6	85	PZ3	100 ³¹	600 ³²	14400
¹¹ 1120910	8	100	50	6	105	PZ3	100 ³¹	600 ³²	14400
¹¹ 1120912	8	120	70	6	125	PZ3	100 ³¹	600 ³²	14400
¹¹ 1120914	8	140	90	6	145	PZ3	100 ³¹	600 ³²	14400
1121006	10	60	10	7	65	PZ3	100 ³¹	600 ³²	14400
1121008	10	80	30	7	85	PZ3	100 ³¹	600 ³²	14400
1121010	10	100	50	7	105	PZ3	50 ³¹	300 ³²	7200
1121012	10	120	70	7	125	PZ3	50 ³¹	300 ³²	7200
1121014	10	140	90	7	145	PZ3	50 ³¹	300 ³²	7200
1121016	10	160	110	7	165	PZ3	50 ³¹	300 ³²	7200
¹⁷ 1121018	10	200	150	7	205	PZ3	50 ³¹	300 ³²	7200

¹⁷ Pre-assembled

¹¹ Not part of the approval

MBR-S Nylon Frame Plug with screw Pozi

