

# MFJ Fiber Jet polyamide



## Features

- Glass-fibre reinforced
- Electrically insulated
- For single plasterboards
- For reduced cavities (Fiber Jet 32 or 25mm)
- Pre installation
- Indoor applications

## Applications

electric switches, pictures, lamps, rails

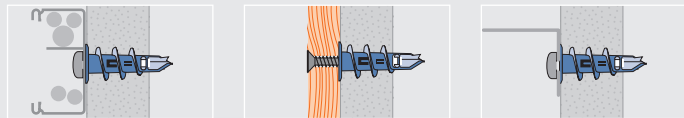

## Technical Data

	Plasterboard d = 12.5mm tension load (N)
MFJ	90

Safety factor of 3 is included / 10 N ≈ 1 kg

## Installation

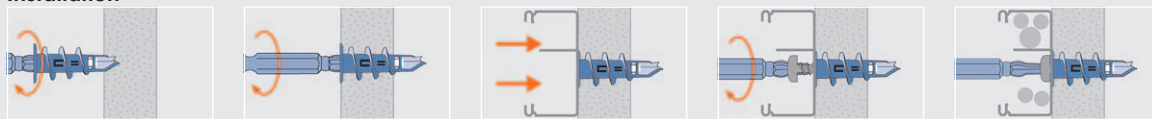

Article code	Length mm L	Screw d <sub>s</sub>	Screwtype metric Ø mm d <sub>s</sub>	Box content FS	Outer carton SK	Quantity per pallet
1801112	32	4.0-4.5	M4	100 13	3600 32	86400

## MFJ32 Fiber Jet polyamide 32mm



Article code	Length mm L	Screw L <sub>s</sub>	Screwtype metric Ø mm d <sub>s</sub>	Box content FS	Unit content	Quantity per pallet
18011127	32	4.0-4.5	M4	100 13	2800	67200

## MFJ32 Fiber Jet polyamide 32mm in Maxi-Box



Article code	Length mm L	Screw Ø mm d <sub>s</sub>	Screw length mm L <sub>s</sub>	Drive	Box content FS	Outer carton SK	Quantity per pallet
18011124	32	4.5	30	PZ2	100 11	2400 32	57600

## MFJ32-S Fiber Jet polyamide 32mm with pan head screw Pozi 2

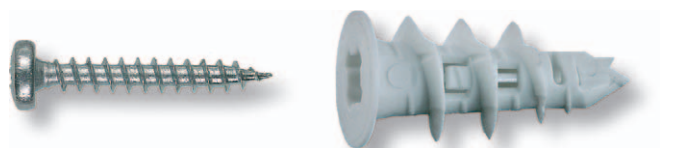

Article code	Length mm L	Screw d <sub>s</sub>	Screwtype metric Ø mm d <sub>s</sub>	Box content FS	Outer carton SK	Quantity per pallet
1801142	25	4.0-4.5	M4	100 13	3600 32	86400

## MFJ25 Fiber Jet polyamide 25mm



Article code	For	Drive	Box content
4001201L	MJP/MFJ	PZ2	1

## BIT Duo-bit for MJP/MFJ

