

# MEF Easy-Fix

## Features

- No pre-drilling in lightweight concrete
- For use with wood, self-tapping and hexagon screws
- Pre installation
- Indoor applications



## Applications

pipes, water conduits, gas conduits

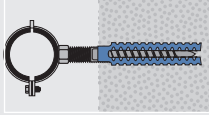

## Technical Data

	Lightweight Concrete tension load (N)
MEF 6/32	220
MEF 8/38	400
MEF 8/60	470
MEF 10/60	520

Safety factor of 3 is included / 10 N  $\approx$  1 kg / Separate drill  $\varnothing$  needed to overcome the resistance in the various building materials. The harder the material, the larger the drill  $\varnothing$ .

## Installation

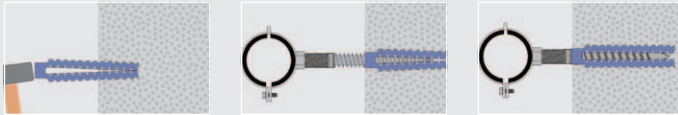

Article code	Plug- $\varnothing$ mm $d_{nom}$	Length mm L	Screw $d_s$	Drilling hole $\varnothing$ mm $d_d$	Box content FS	Outer carton SK	Quantity per pallet
1127074	6	32	5-6	7-9	100 01	2400 22	57600
1127075	8	38	6-8	10-12	100 11	1200 22	28800
1127076	8	60	6-8	10-12	100 31	600 22	14400
1127077	10	60	8-10	12-14	100 31	600 22	14400

## MEF Easy-Fix

